

EXPLODED VIEW

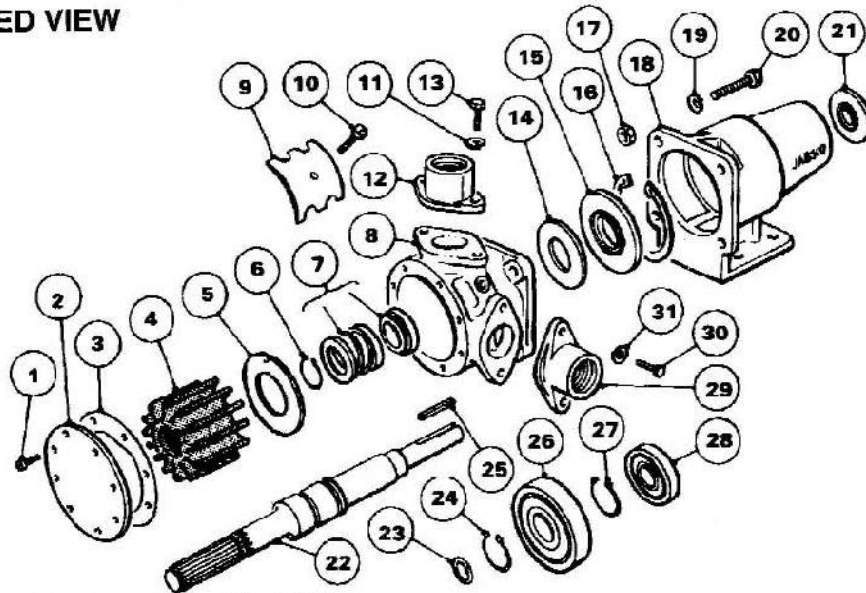

Pump now obsolete - Data for spare Parts Only

PARTS LIST 9440-200

Key	Description	Qty	Part No	Key	Description	Qty	Part No
1	Endcover Screw*	8	SP1006-05	17	Nut	4	SP1085-15
2	Endcover	1	9448	18	Bearing Housing	1	3206
3	Gasket*	1	3209	19	Lock Washer	4	SP1608-02
4	Impeller*	1	2999-0001B	20	Bolt	4	SP1095-29
5	Wearplate	1	9316	21	Bearing Seal	1	SP2700-58
6	Retaining Ring	1	SP1700-143	22	Shaft	1	3207
7	Seal Assembly*	1	9309	23	O' Ring*	1	SP2000-54
8	Body	1	9444	24	Retaining Ring	1	SP1700-196
9	Cam	1	9446	25	Key	1	9214
10	Cam Screw	1	SP1008-03	26	Ball Bearing	1	SP2600-16
11	Lock Washer	2	SP1608-04	27	Retaining Ring	1	SP1700-196
12	Port Adaptor	1	9443	28	Ball Bearing	1	SP2600-15
13	Port	2	SP1095-30	29	Port Adaptor	1	9443
14	Slinger	1	3212	30	Bot	2	SP1086-30
15	Bearing Seal	1	SP2700-59	31	Lock Washer	2	SP1608-04
16	Retaining Ring	1	SP1761-433				

Service Kit SK207 contains Parts marked*

SERVICE INSTRUCTIONS

Dis-Assembly Inspect all parts for wear or damage and replace if necessary

1. Remove endcover screws, endcover and gasket.
2. Remove impeller using extractor supplied with pump. The two bolts in the extractor locate into two holes in impeller hub. Screw centre bolt to extract impeller.
3. Loosen cam screw and remove cam, (cleaning off any old jointing compound).
4. Remove wearplate.
5. Remove "O" ring and retaining ring to remove seal assembly. Note: If this proves difficult, remove pump body from the bearing housing by unfastening the four retaining bolts, then press out seal assembly from the pump body.
6. Remove slinger.
7. Remove the bearing seal using a small screwdriver by levering at the outer diameter of the seal. Do not touch the lip of the seal.
8. Remove retaining ring from the bearing housing.
9. Remove key from shaft and remove burrs from shaft area. Remove the outer bearing seal and then press shaft and bearing assembly towards impeller end.
10. Press shaft through the smaller bearing whilst supporting the inner race of the bearing.
11. Remove the retaining rings of the larger bearing and press shaft through the bearing towards the impeller end whilst supporting the inner race of the bearing.

Assembly

1. Fit the retaining ring for the larger bearing at the impeller end of shaft.
2. Press shaft through the larger bearing until the bearing touches the retaining ring, whilst supporting the inner race of the bearing, do not force the bearing against the retaining ring.
3. Fit the second retaining ring.
4. Press shaft in the smaller bearing whilst supporting the inner race.
5. Press shaft and bearing into the bearing housing.
6. Fit retaining ring into bearing housing.
7. Fit the larger lip seal. Press seal of the smaller bearing flush with the end of the bearing housing. Take care that seals are installed with the springs face away from the bearings.
8. Fit slinger to the shaft.
9. Fit pump body to the bearing housing by its four fixing bolts.
10. Replace seal seat and "O" rings. Install seal assembly with carbon face against coal seat. Compress the spring with the spring washer and install the retaining ring.
11. Coat cam screw threads and top of cam with 4 mm setting jointing compound. Install in body.
12. Lightly grease the walls of impeller bore and the shaft splines with a good quality grease. Push impeller into pump bore with a rotary motion in the direction of the rotation of the pump, whilst exerting pressure with the hand palm until the impeller splines engage with the shaft splines. Note: To raise assembly use a wooden mallet and block of wood; it is possible to complete the installation of the impeller with not more than 1/2" protruding from the pump by tightening the endcover screws.
13. Fit gasket, endcover screws and endcover.

INSTALLATION DRAWING

