



**Models: 17800-1000
17800-1024**

PORTA QUICK OIL CHANGER

FEATURES

- Pump Body:** Bronze construction
- Impeller:** Nitrile (oil resistant)
- Shaft Seal:** Lip Type
- Motor:** Reversible with integral reversing switch
- Container:** Plastic with 14 quart capacity
- Power Cord:** 8 feet with alligator clips
- Suction Hose:** 4 feet of neoprene hose with 40 inch Teflon* dipstick probe
- Dimensions:** 13-1/2" (343 mm) diameter,
13-5/8" (354 mm) high
- Weight:** 9 lb (4,1 kg)

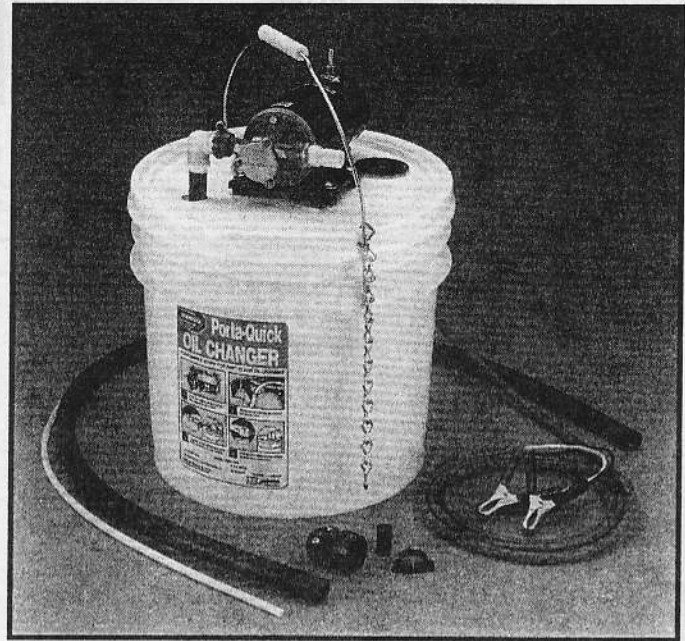

Models: 17800-0000 & 17800-1024

OPERATING INSTRUCTIONS

1. Run the engine approximately 5 minutes to heat oil (minimum oil temperature 140°F; maximum 185°F), then shut off engine prior to oil removal.
2. Push the 1/2" suction hose onto the pump inlet hose fitting. Position one hose clamp on the end and tighten to secure the hose to the hose barb.
3. If using the 1/4" dipstick probe (instead of the Female Garden Hose Connector), insert the probe into the 1/4" x 1/2" (approximately 1" long) rubber bushing until the end of the probe and the bushing are flush with each other. Slide the hose clamp over the end of the 1/2" hose and position the end of the plastic probe, with bushing attached, in the end of the suction hose. Slide the hose clamp to a position where it will be approximately centered over the probe/hose bushing, and with a pair of pliers, squeeze it together very tightly to affect a positive airtight seal.

If using the Female Garden Hose Fitting, install it onto the end of the 1/2" suction hose by inserting the 1/2" barb fitting into the hose and secure it by screwing together the two halves of the plastic clamp on the hose at the position of the barb.

4. Clamp the power cord alligator clips (red to positive and black to negative) to the terminals of an appropriate voltage battery.

MODEL NUMBER	VOLTAGE	AMP DRAW	FUSE SIZE
17800-1000	12	7	10
17800-1024	24	4	7

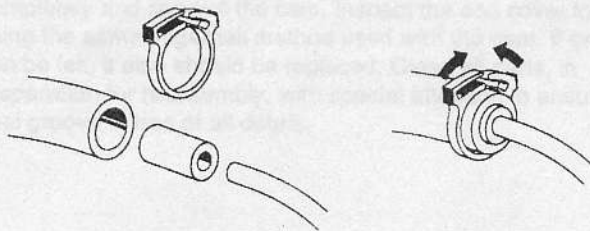

⚠ WARNING Explosion hazard. Motor switch must be in "OFF" position when connecting and disconnecting alligator clips to battery terminal and ground. The switch in an "ON" position can cause an electrical spark which can result in explosion. Injury or death can occur.

⚠ WARNING Explosion hazard. Take necessary precautions to rid area around battery of potentially explosive gases. Continue ventilation during oil changing procedure. Failure to do so can result in explosion. Injury or death can occur.

Teflon* is a trademark of E.I. DuPont de Nemours and Company.

Four simple steps for fast, clean oil changes

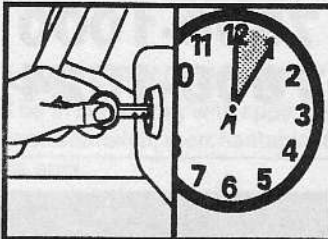

STEP 1

Start engine and run for 5 minutes to heat the oil

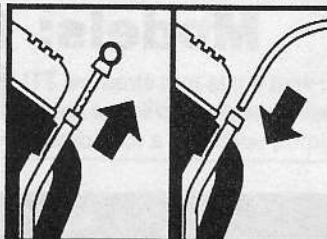

STEP 2

Remove the dipstick and insert the probe tube

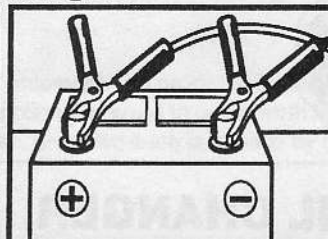

STEP 3

Attach the power cord clips to the engine's battery

Orange = Positive
Black = Negative

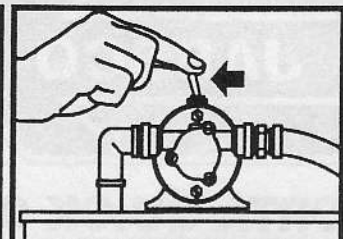

STEP 4

Flick the pump motor switch to drain the crankcase

- If using the 1/4" dipstick probe, insert it into the dipstick tube until it hits the bottom of the pan. If it is not obvious when the probe hits the bottom of the pan, it may be helpful to measure the distance from the top of the dipstick tube to the bottom of the pan and mark this length on the probe with a piece of tape. Once the probe has hit the bottom of the pan, pull it back up about 1/8" - 1/4" and hold the probe in that position or secure it with some tape during the oil removal process.

NOTICE: Do not push the dipstick probe too far into the engine or it may get caught on internal components and cause a problem when removing.

If using the Female Garden Hose Fitting, simply screw it onto the Male Garden Hose Thread, when provided, on the top of the dipstick tube until it is tight enough to ensure an airtight seal. It is important, when using this method, that the hose washer in the garden hose fitting is pliable and in good serviceable condition to ensure there is no air leak at this joint, which will cause the pump to not prime itself.

CAUTION Engine oil is hot. Wear protective gloves and safety glasses when handling heated oil. Failure to do so may result in personal injury.

- The pump is reversible so it can pump oil in either direction. The switch (at rear of motor) has two "on" positions when it is moved to either side of center with the center position being the "off" position. To remove oil from the engine, move the switch in the direction of required flow. If using the 1/4" probe, watch for oil flowing through it. If oil does not appear in about 10 seconds, check the probe for possible sediment blockage and remove if present. When the oil has been removed from the engine, the pump speed will increase causing a raised pitch in the sound of the pump. When this occurs, switch off the pump within thirty seconds to avoid damage to the pump's impeller.

NOTICE: If the motor does not turn when first switched on, switch off the pump and loosen each of the end cover screws a couple of turns. Switch the pump on until the motor turns and then switch it off again. Retighten the end cover screws and start the oil removal process again.

- The motor will overspeed when the oil has been pumped out of the engine. Switch off the pump immediately to avoid impeller damage. Do not leave the pump unattended while pumping oil from the engine. Normal 6 quart pump-out takes less than 3 minutes.
- After all the oil has been removed from the engine, disconnect the alligator clips from the battery and carefully remove the dipstick probe from the dipstick tube. Coil the suction hose and probe into a bundle and secure them to the container handle with the chain hanger ensuring the probe end is pointing up to avoid dripping. Coil the power cord and secure it to the handle with the other chain hanger.
- To empty the container with the pump when appropriate electrical power is nearby, remove 1/4" probe from the 48" hose and insert hose end in an approved receptacle. Do not attempt to discharge oil through the 1/4" probe. Connect the power cord to the proper power supply and switch on the pump by moving the switch toggle in the direction of desired flow. If proper electrical power is not available, pull up the retractable pour spout and carefully pour oil into a suitable receptacle.

NOTICE: Always recycle used oil in compliance with federal and local legislation. Handle petroleum products in an environmentally responsible manner.

EXPLODED VIEW

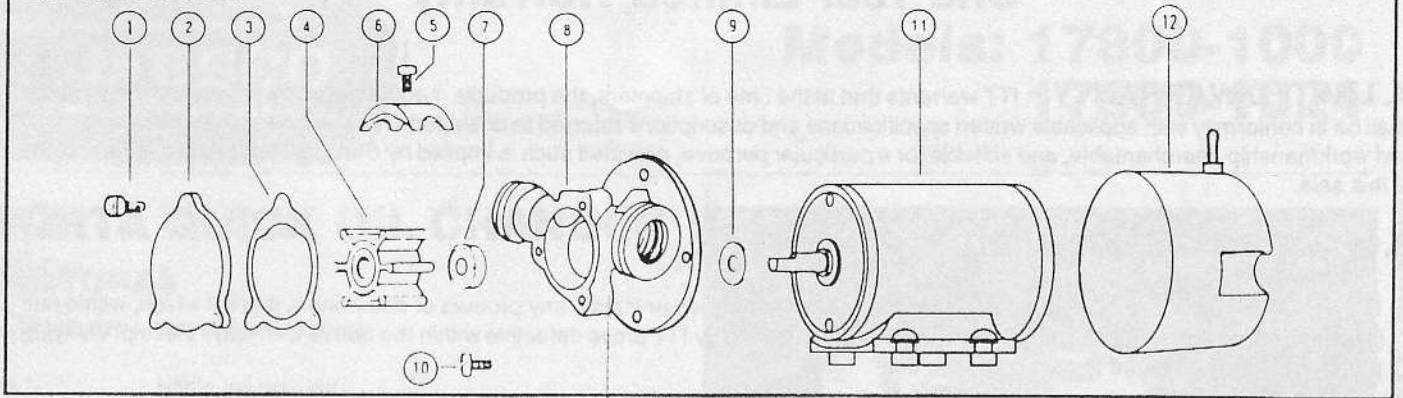

KEY	DESCRIPTION	PART NUMBER	QTY.	KEY	DESCRIPTION	PART NUMBER	QTY.
1	Screw (End Cover)	91002-0090	3	8	Body	7824-0000	1
2	End Cover	12076-0000	1	9	Slinger	6342-0000	1
3*	Gasket	7828-0000	1	10	Screw (Body to Motor)	98019-0060	2
4*	Impeller, Nitrile	14750-0003	1	11	Motor 12 Vdc	18753-0067	1
5	Screw (Cam)	91002-0010	1		Motor 24 Vdc	18753-0623	1
6	Cam	8089-0000	1	12	Switch/Housing Assy.	18753-0069	1
7*	Seal	93000-0100	1		Service Kit, Nitrile	90092-0004	
					Replacement Pump Head	9040-0005	

SERVICE INSTRUCTIONS

IMPELLER REPLACEMENT

To replace the pump's flexible impeller, remove the three end cover screws, end cover and gasket. Then grasp the hub of the impeller with a pair of pliers and pull the impeller from the pump body using a rotary motion.

Lubricate the inside of the impeller bore with a thin coat of oil or lightweight grease. Install a new impeller by pushing it into the pump body with a rotary motion until the flat of the impeller insert aligns with the flat of the shaft, then push it firmly into the body. Position a new end cover gasket on the pump body and reinstall the end cover securing it with the three end cover screws.

MAJOR SERVICE

Remove the pump impeller by following the above impeller replacement instructions. Remove the two screws that secure the pump body to the motor. Slide the body assembly off the motor shaft until it is clear of the shaft then lift the assembly with discharge tube attached up and away from the container. With a pair of needle-nose pliers, reach into the seal bore area, grab the lip of the seal and pull it from the seal bore. Inspect the cam for damage. Also inspect it for wear by rubbing a fingernail across it to feel for wear grooves. If it has noticeable wear grooves, it should be replaced. Remove the cam by loosening the cam screw about two turns and smack the head of it to break the cam loose from the body. Remove the cam screw completely and remove the cam. Inspect the end cover for wear using the same fingernail method used with the cam. If grooves can be felt, it also should be replaced. Clean all parts, in preparation for reassembly, with special attention to ensure the seal groove is free of all debris.

* Parts contained in Service Kit

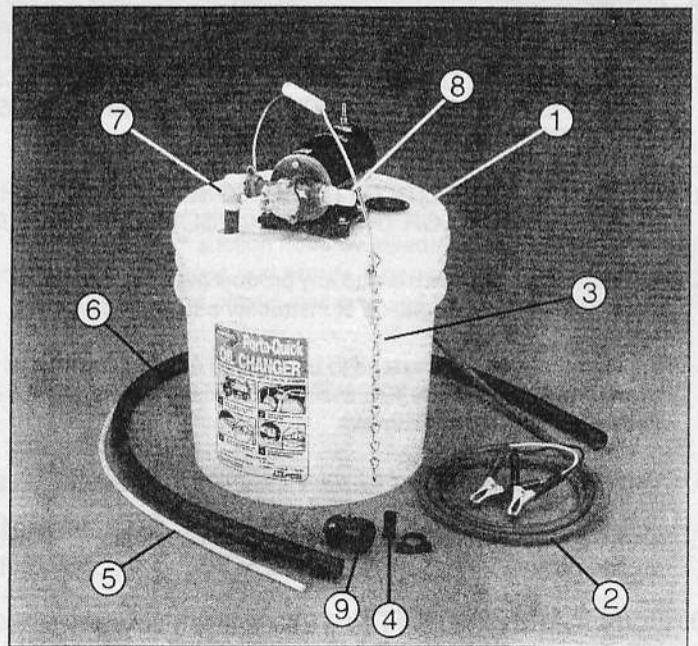

KEY	DESCRIPTION	PART NUMBER	QTY.
1	Lid	17794-0000	1
2	Power Cord	43922-0000	1
3	Pail	17089-0000	1
4	Hose Adaptor Sleeve	34423-1000	1
5	Dipstick Probe	18753-0608	1
6	Hose	17795-0000	1
7	Port Elbow & Tube	17834-1000	1
8	Port Adaptor Straight	93009-0190	1
9	1/2" Hose by Female Garden Hose Thread Fitting	*	1

* Available from Hardware Store.

One Year Limited Warranty

A. LIMITED WARRANTY: ITT warrants that at the time of shipment, the products manufactured by ITT and sold hereunder shall be in conformity with applicable written specifications and descriptions referred to or set forth herein, free from defects in material and workmanship, merchantable, and suitable for a particular purpose, provided such is implied by State law under the circumstances of this sale.

B. WARRANTY ADJUSTMENT:

1. ITT agrees to repair or furnish a replacement for, but not to remove or install, any product or component thereof which, within one (1) year from date of purchase, shall upon test and examination by ITT prove defective within the above warranty. Receipt verifying purchase date is required to obtain adjustment.
2. Buyer shall notify ITT of any defect within this warranty no later than ninety (90) days after the defect is discovered.
3. No product will be accepted for return or replacement without the prior written authorization of ITT. Upon such authorization, and in accordance with instructions from ITT, the product will be returned to ITT, shipping charges prepaid by Buyer. Products returned to ITT will be addressed as follows:

ITT JABSCO
1485 Dale Way
Costa Mesa, California 92626-3998

Or to such alternate locations as may be designated on the product, its container, or this sheet.
Repair or replacement made under this warranty will be shipped prepaid to Buyer.

C. EXCLUSIONS FROM WARRANTY AND LIMITATION OF LIABILITY:

1. The foregoing warranty is limited solely as set forth herein and applies only for the period designated above.
2. ITT SHALL NOT BE LIABLE FOR ANY LOSS, DAMAGE, SPECIAL OR CONSEQUENTIAL DAMAGE OF ANY KIND, WHETHER BASED UPON WARRANTY, CONTRACT, NEGLIGENCE, OR STRICT LIABILITY ARISING IN CONNECTION WITH THE SALE, USE, OR REPAIR OF THE PRODUCT.
3. THE MAXIMUM LIABILITY OF ITT IN CONNECTION WITH THIS WARRANTY SHALL NOT IN ANY CASE EXCEED THE CONTRACT PRICE FOR THE PRODUCT CLAIMED TO BE DEFECTIVE OR UNSUITABLE.
4. This warranty does not extend to any product manufactured by ITT which has been subjected to misuse, neglect, accident, improper installation, or use in violation of instructions furnished by ITT.
5. This warranty does not extend to or apply to any unit which has been repaired or altered at any place other than ITT's factory, or by persons not expressly approved by ITT, nor to any unit the serial number, model number, or identification of which has been removed, defaced or changed.
6. Components manufactured by any supplier other than ITT shall bear only that warranty made by the manufacturer of that product.
7. This warranty applies to products defined as "consumer products" by the Consumer Product Warranties Act as from time to time amended.

D. CONSUMER RIGHTS: This warranty gives you specific legal rights, and you may have other rights which vary from state to state. Some states do not allow exclusion or limitation of damages.

STANDARD WARRANTY: If the products manufactured and sold hereunder are not Consumer Products, the warranty extended to Buyer shall be as set forth in subparagraphs (A), (B), and (C), **EXCEPT THAT ALL EXPRESS OR IMPLIED WARRANTIES OR MERCHANTABILITY OR SUITABILITY FOR ANY PARTICULAR PURPOSE ARE EXCLUDED.**

ITT Jabsco

A Unit of ITT Fluid Technology Corporation



U.S.A.
ITT Jabsco
1485 Dale Way, P.O. Box 2158
Costa Mesa, CA 92628-2158
Tel: (714) 545-8251
Fax: (714) 957-0609

UNITED KINGDOM
ITT Jabsco
Bingley Road, Hoddesdon
Hertfordshire EN11 0BU
Tel: +44 (0) 1992 450145
Fax: +44 (0) 1992 467132

CANADA
ITT Fluid Products
55 Royal Road
Guelph, Ontario N1H 1T1
Tel: (519) 821-1900
Fax: (519) 821-2569

JAPAN
NHK Jabsco Company Ltd.
3-21-10, Shin-Yokohama
Kohoku-Ku, Yokohama, 222
Tel: 045-4758906
Fax: 045-475-8908

GERMANY
MINTEC GmbH
Oststrasse 28
22844 Norderstedt
Tel: +49-40-53 53 73 -0
Fax: +49-40-53 53 73 -11