

To operate your JABSCO automatic water pressure system, be sure the water tank is full, properly vented, all plumbing connections are air tight and correct wiring connections have been made.

1. Open the faucet farthest from the tank and let water run for a few seconds. The indicator light should be on when the pump is running. Close the faucet. The pump should shut off almost immediately, the indicator light should go out and both should remain off until a faucet is opened.
2. If indicator light shows the pump is running with all faucets closed turn switch off immediately and check the following:
 1. Water tank may be empty. Fill the tank.
 2. Battery may be low or discharged. Recharge battery.
 3. Impeller may be fatigued. Replace the impeller.

3. If the pump cycles on and off with all faucets closed, check the following:
 1. Leaking faucet or plumbing system. Correct the leak.
 2. Leak back thru the check valve. Clean the check valve seat.

The pressure switch control is preset and tested at the factory. Operating pressures are 8 PSI on 20 PSI off. Do not tamper with switch adjustment, this will void the warranty.

The JABSCO pump switch panel has been developed to provide added operating convenience and built-in overload fuse protection. Use only the correct fuse size marked on the panel to protect the pump from overload. It is suggested that the switch be turned to off when the water system is not used for extended periods or over night.

HEAD CAPACITY TABLE

| Lbs. Per Sq. In. | GPM | Ampere Draw |
|------------------|-----|-------------|
| Free Flow | 2.1 | 4.8 |
| 5 | 2.0 | 4.9 |
| 10 | 1.7 | 5.1 |
| 15 | 1.4 | 5.3 |
| 20 | 1.0 | 5.7 |

EXPLODED VIEW

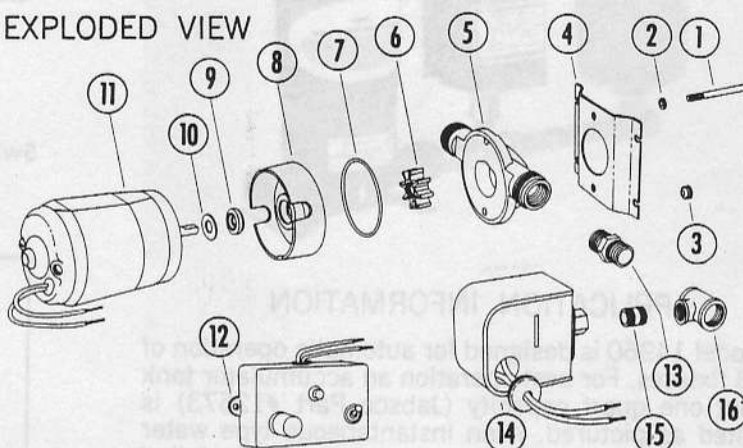

SERVICE INSTRUCTIONS

Normal service may be easily performed by using the parts in service kit #SK-158-01-37.

- Disconnect motor leads from pressure switch.
- Remove body screws (Key 1) and slide pump head off motor assembly.
- Replace impeller, seal assembly and O Ring. Use pipe compound or similar sealant around outside diameter of metal seal cup when replacing in seal housing.
- Reassemble on motor. Tighten body screws evenly to avoid cocking base plate on body.

For replacement parts or additional service help see your local JABSCO dealer.

PARTS LIST

| Key | Description | Part No. | Qty. |
|-----|-------------------------|-------------|------|
| 1 | Screw | SP1003-20 | 2 |
| 2 | Lock Washer | SP1602-02 | 2 |
| 3 | Grommet | SP2900-12 | 4 |
| 4 | Base | 14945 | 1 |
| 5 | Body | 12375 | 1 |
| 6 | Impeller | 14750-37 | 1 |
| 7 | "O" Ring | SP2000-75 | 1 |
| 8 | Seal Housing | 12314 | 1 |
| 9 | Seal Assembly | SP2700-91 | 1 |
| 10 | Slinger | 6342 | 1 |
| 11 | Motor | SP8012-02 | 1 |
| 12 | Switch Panel | 14963 | 1 |
| 13 | Check Valve | SP8024-01 | 1 |
| 14 | Pressure Switch | SP6070-12 | 1 |
| 15 | Nipple | SP2800-06 | 1 |
| 16 | Tee | SP8023-06 | 1 |
| — | Service Kit (Not Shown) | SK158-01-37 | — |

Variations Available

| | | |
|--------------|-----------------------------------|------------------|
| 6 Volt D.C. | MODEL 14950-01, less switch panel | Motor SP-8012-01 |
| 12 Volt D.C. | MODEL 14960-01, less switch panel | Motor SP-8012-02 |
| 24 Volt D.C. | MODEL 14970-01, less switch panel | Motor SP-8012-03 |
| 32 Volt D.C. | MODEL 14980-01, less switch panel | Motor SP-8012-04 |

ITT JABSCO PRODUCTS

A Unit of International Telephone and Telegraph Corporation, 1485 Dale Way, Costa Mesa, California 92626