



VFLO 5.0

5.0 GPM WATER PRESSURE PUMP

Powered by the revolutionary DiMOND technology.

JABSCO's V-FLO variable flow, constant pressure water pumps now feature the revolutionary new DiMOND technology designed to automatically diagnose and monitor all aspects of your pump's performance to prevent system failure. DiMOND incorporates eight specific modules designed to Monitor, Protect and Prevent - allowing you to evaluate and respond to the problem before the pump or your boat are damaged.

The DiMOND technology automatically runs diagnostics to detect common failures such as run dry, plumbing leaks, over current, under current, low voltage and over voltage. If the diagnostic discovers a problem, the pump will stop, identify the root cause, and provide the data you need to solve the problem.

V-FLO is powered by a new variable speed drive that delivers the exact amount of water flow needed to perform a variety of onboard delivery tasks. Since the pump is constantly monitoring water flow and electrical current, it automatically adjusts itself as needed, ensuring that your systems are operating at peak efficiency.

Features and Benefits

- 5.0 gallons per minute (19 liters)
- DiMOND technology provides consistent water pressure
- Up to 50% less power consumption
- Learns the boat's water pressure system to improve pump performance



a xylem brand

VFLO 5.0 5.0 GPM WATER PRESSURE PUMP

Specifications

Pump: 4 Chamber Positive displacement diaphragm design. Self-Priming up to 10 feet suction lift. Pump able to run dry without damage. Removable port adapters.

Motor: Permanent magnet, double ball bearing armature.

Kit Includes



Wiring Diagram

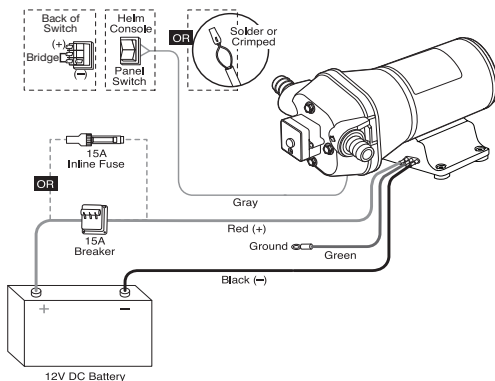

Typical Installation Layout

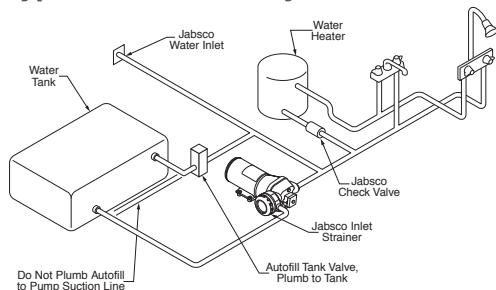

The Difference Between a Pump and a Pumping System

If the pump is the heart of your boat's water system, then Jabsco's DiMOND technology is the brain. DiMOND technology looks at the water system as a whole and controls the pump accordingly. The underlying philosophy is to **monitor** the system, **protect** it from failure, and to **prevent** any damage.

Monitor

The DiMOND technology continuously monitors system operational status in order to detect common water system problems. Pump failures due to run dry conditions or electrical anomalies are a thing of the past. Plumbing leaks are also a major concern with water systems and the DiMOND technology can detect those as well. With six different diagnostics being monitored, you can be assured your water system is functioning properly.

Protect

When system monitoring detects a problem, DiMOND technology shuts down the pump to safeguard your boat and water system. Diagnostic indicator lights on the on/off switch tell you the source of the problem giving you a head start on trouble shooting and repairing the system.

Prevent

Because problems in the system are recognized quickly, you have time to evaluate and respond before the pump or your boat are damaged. Preventing problems are important, but preventing a critical problem like the complete loss of all potable water can be life saving.

DiMOND Modules



Learn more about DiMOND technology, visit us online at www.itfflowcontrol.com/DiMOND.

Model	Nominal DC Volts	Max Fuse	Open Flow GPM (LPM)	Operating Pressure PSI (Bar)	Cut-Out Pressure PSI (Bar)
42755-0092	12V DC	15A	5.0 (19)	40 (2.75)	60 (4.1)
42755-0094	24V DC	10	5.0 (19)	40 (2.75)	60 (4.1)
42755-0392	12V DC	15A	5.0 (19)	25 (1.72)	35 (2.4)
42755-0394	24V DC	10A	5.0 (19)	25 (1.72)	35 (2.4)



Warranty: All products of the company are sold and all services of the company are offered subject to the company's warranty and terms and conditions of sale, copies of which will be furnished upon request. The information provided herein is for guidance only, it does not constitute a guarantee of the performance or specification of any individual product or component.

www.xylem.com

USA
Xylem, Inc.
Cape Ann Industrial Park
Gloucester, MA 01930
Tel: (978) 281-0440
Fax: (978) 283-2619

UK
Xylem, Inc.
Bingley Road, Hoddesdon
Hertfordshire EN11 0BU
Tel: +44 (0) 1992 450145
Fax: +44 (0) 1992 467132

GERMANY
Xylem, Inc.
Oststrasse 28
22844 Norderstedt
Tel: +49-40-53 53 73-0
Fax: +49-40-53 53 73-11

JAPAN
NHK Jabsco Company Ltd.
3-21-10, Shin-Yokohama
Kohoku-Ku, Yokohama, 222-0033
Tel: +81-045-475-8906
Fax: +81-045-477-1162

ITALY
Xylem, Inc.
Via Tommaseo, 6
20059 Vimercate, Milano
Tel: +39 039 685 2323
Fax: +39 039 666 307